

**MAIN DATA**

Length over all .....	85.60 m
Deck area .....	446 m <sup>2</sup>
Hangar deck area.....	224 m <sup>2</sup>
Mezzanine deck area.....	150 m <sup>2</sup>
Speed .....	15.0 knots

**WINDFARM SUPPORT /  
LIGHT CONSTRUCTION VESSEL**

- Rebuilding of Vestland Cygnus
- Accommodation module for 112 persons
- 100 T Offshore crane, with 40 m outreach
- Gangway system for transfer personnel to offshore installations
- Special Purpose Ship



**WÄRTSILÄ**  
**VS485 mk.III WSV**  
 WIND MILL SERVICE VESSEL

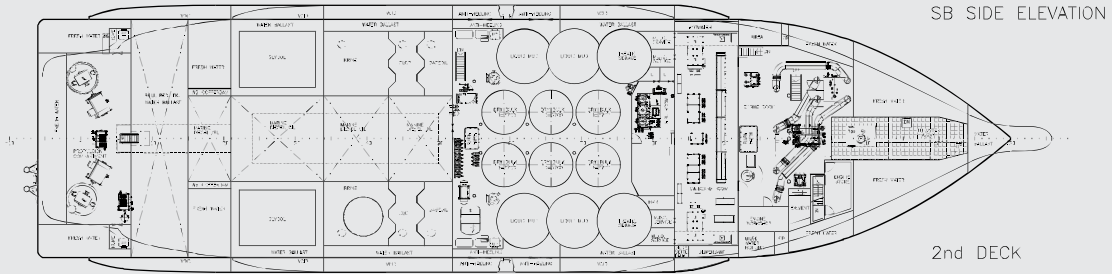
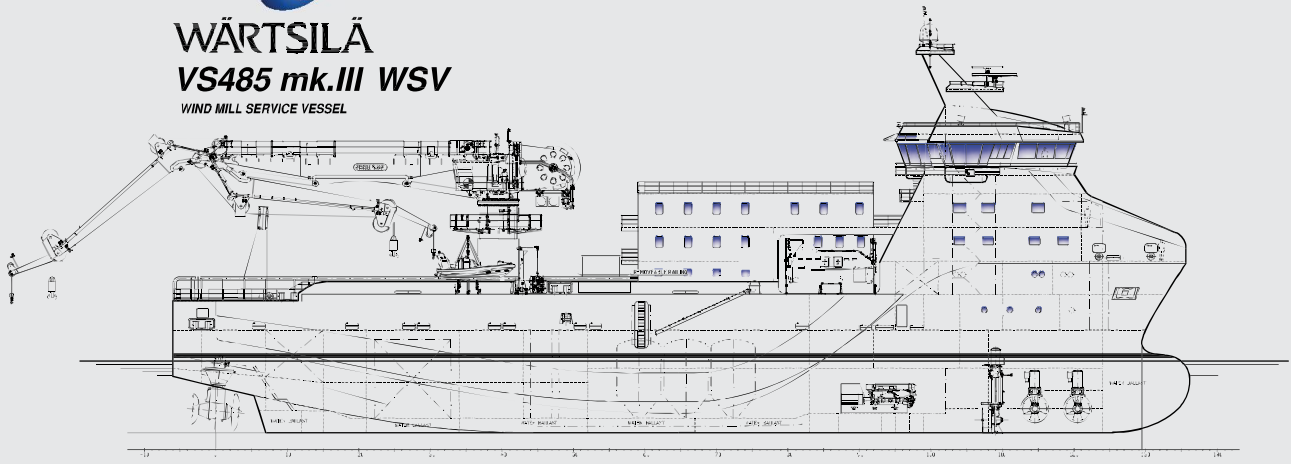

SB SIDE ELEVATION

2nd DECK

**MAIN DIMENSIONS**

Length over all	85.60 m
Length between p.p.	77.70 m
Breadth moulded	22.40 m
Depth to 1st Deck	8,60 m
Deck area:	446 m <sup>2</sup>
Deadweight @ 7.15 m	5400 tonnes

**CAPACITIES**

Ballast water / Drillwater	2470 m <sup>3</sup>
Fresh water	1000 m <sup>3</sup>
Dry bulk	330 m <sup>3</sup>
Liquidmud	700 m <sup>3</sup>
Base oil	200 m <sup>3</sup>
Brine	430 m <sup>3</sup>
Glycol/ Special products	290 m <sup>3</sup>
MDO cargo	900 m <sup>3</sup>
Mud slop	185 m <sup>3</sup>

**CLASS**

DnV, + 1A1, SPS, ICE-C, DYNPOS AUTR, CLEAN DESIGN, E0, Naut OSV(A), COMF-V(3)C(3), SF, Register notations dk(+), HL (p), Crane

ERN	99.99.99.95
SPEED	
Speed	15.0 knots

**MACHINERY AND PROPULSION**

Main generator sets (4 x Wärtsilä 9L20)	4 x 1580 ekW
Emergency generator	1 x 178 kW
FWD tunnels (Brunvoll)	2 x 1000 kW
Fwd retractable (Brunvoll)	1 x 880 kW
Steerable Thruster (Steerprop)	2 x 2200 kW

**ELECTRICAL SYSTEM**

Wärtsilä Low Loss Concept - 690 V

**ACCOMMODATION**

The vessel is built with a compliment for totally 22 persons  
 Accommodaton block for totally 112 persons

**DECK EQUIPMENT**

AHC Offshore crane	1 x 100t @ 40 m
--------------------	-----------------

**REFERENCE**

Owner	Vestland Offshore AS
Shipyard	Fjellstrand AS
Design ID	VS 485 MK III WSV
Reference number	4778003
E-mail for info	shipdesign@wartsila.com
Details are believed to be correct but not guaranteed	